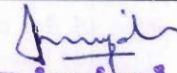

MAHARASHTRA UNIVERSITY OF HEALTH SCIENCES, NASHIK

INFRASTRUCTURE DETAILS

Sr. No.	Particulars to be verified	Details on College Website	Adequate/ Inadequate
College			
1	Land details: Total land, owner, unitary or not, NA of all land, 7/12 extracts of all land (Applicable only to Private Colleges). (Verify land documents & Government permissions documents are uploaded on College Website. No Land/ Construction documents shall be submitted to the University. Only deficit information to be pointed out to the University).	Yes/No	Adequate
2	Total constructed area of college building		
	(I) Administrative Section: Total Area: 21654 sq.ft (which includes) Principal Room, P.A. Room, Reception cue Visitors lounge, Meeting hall, Account section, Record and Central store etc.	Yes/No	Adequate
	(II) Lecture Halls: a) Total No. of Lecture Halls 6 b) IT enabled, Audio / Video teaching Aids 6 c) Total area for lecture Halls .5400	Yes/No	Adequate
	(III) Seminar or Conference or Examination Hall: a) Total Area 900 .Sq.ft. b) Total Seating Capacity 40... c) Audio / Video System and Other Facilities Yes	Yes/No	Adequate
	(IV) Central Library: a) Total Area : 1800 . sq.ft. Total No. of Books 6108 . Distribution of books . . . Yes . . . Capacity of Reading Hall :- for Students .80 for Teachers .15 . . . No. of Scientific Journals . . . 91 . . . No. of News Papers . . . 8 Photo Copier Machine .Yes . . . Drinking water & Washrooms. Yes b) Digital Library : FTTH internet No. of Computers 1 Internet Facility	Yes/No	Adequate
	(V) Teaching Departments: There shall be Five Teaching Departments as per MSR No. of departments 5 Departmental Area, No. of Books/ Charts / Models / Spacimens (dry and wet) / Museum in each department information to be uploaded on college website.	Yes/No	Adequate
	(VI) Laboratories : Laboratories : As per MSR (. 4452 Sq.ft.) Nursing Foundation and Medical Surgical Nursing Lab (1500 Sq.ft.), CHN (900 Sq.ft.), Nutrition (900Sq.ft.), OBG and Paediatric (900Sq.ft.), Pre-Clinical Science (900Sq.ft.), Advanced Nursing Skill Lab (900Sq.ft.), Computer Lab (1500Sq.ft.), with 10 computer as per Intake capacity, AV Aids (600Sq.ft.), well Equipped Lab must have Mannequins, Articles & Beds as per MSR & INC Norms	Yes/No	Adequate
	(VII) Auditorium:- (As per MSR) Auditorium should be spacious enough to accommodate at least double the sanctioned/actual strength of students, so that it can be utilized for hosting functions of the college, educational conferences/ workshops, examinations etc. It should have proper stage with green room facilities. It should be well - ventilated and have proper lighting system. There should be arrangements for the use of all kinds of basic and advanced audio-visual aids. OR Multipurpose Hall:- College of Nursing should have multipurpose hall, if there is no auditorium.	Yes/No	Adequate

	(VIII) Canteen and Kitchen Facility: [Note: Verify Canteen Facility & Hygiene is monitored as per MUHS Circular No.18/2019 dated 19/03/2019.]	Yes/No	
	(IX) Common Rooms: Separate common rooms for boys and girls with adequate space and sitting arrangement shall be available. *	Yes/No	Adequate
3	University Examination Infrastructure: Strong Room for examination a) (Area- 300 sq.ft, b) Shelf, c) Steel cupboard – 1, d) CCTV, Photocopier Machine, Examination hall with benches, Parking Facility for University vehicle, Guest house facility	-	Adequate
4	Other facilities: Hospital Waste Management, Medical Education Unit, Intercom Network, Playground, P.T Teacher or Instructor, Cafeteria, Facility for indoor games, Gymnasium / Gymkhana Facility, Is there any LMS (learning management system software) available	Yes/No	Adequate
5	Hostel facility: Boys (UG & PG), Girls (UG & PG), Interns, Residents, Warden/ Rector, Hygiene, Vending Machine etc.	Yes/No	Adequate
Hospital			
6	Hospital Details	Details on College Website	Adequate/ Inadequate
	Name of the Hospital : Bel Air Hospital	Yes/No	Adequate
	Address: Dalkeith, Panchgani, Dist - Satara		
	Telephone No. : 02168 241897		
	Bed Strength : 200		
	Distance of Hospital from the College to which it is attached (in kms) Same Campus		
	Number of beds registered as per BNH Act	Yes/No	Adequate
7	I. Total constructed area of Hospital Building as per MSR (.....Sq.mtr. / Sq.ft.)	Yes/No	Adequate
	Whether the Hospital is Owned by the College / Management or Rented ?	Yes/No	Adequate
	II. Hospital Administration Block as per MSR (Superintendent room, Deputy Superintendent room, Medical officers' room, Matron room, Assistant Matron room, Reception and Registration, etc.)	Yes/No	Adequate
	III. Out-Patient Departments (OPD) as per MSR Total Area of OPD Complex ...Sq.ft. 3450 No. of OPD's 11 Facilities shall be as per MSR & all details shall be on college website.	Yes/No	Adequate
	IV. In Patient Departments (IPD) as per MSR Total Area of IPD Complex ...Sq.ft. 27200 Sqft No. of IPD Departments.9..... Bed Distribution..... Attached Facilities shall be as per MSR & all details shall be on college website.	Yes/No	Adequate
	V. Operation Theatres Block as per MSR Total Area of OT Block ...sq.ft.9245 No.of OTs available ...2.... Facilities shall be as per MSR & all details shall be on college website.	Yes/No	Adequate
	VI. Casualty Facilities State Government Permission Letter	Yes/No	Adequate
	VII. Central Clinical Laboratory: Well-equipped with separate sections for Pathology, Biochemistry and Micro-biology. Attached toilet shall be there for collection of urine samples. Other diagnostic tools for ECG or TMT etc. shall be provided.	Yes/No	Adequate
	VIII. Radiology or Sonography Section: Radiologist chamber, X-ray room, Dark room, film drying room, store room, patients waiting and dressing room, reception or registration or report room.	Yes/No	Adequate
	IX. Labour Room :	Yes/No	Adequate

Principal

Bel-Air College of Nursing

Dean/ Principal Stamp & Signature

**INDIAN RED CROSS SOCIETY
BEL-AIR COLLEGE OF NURSING, PANCHGANI
NURSING FOUNDATION LAB INVENTORY**

Sr.No	Name of the articles	No. of articles
1	Sterilizer with wire	1
2	Steel drums	2
	PHYSICAL EXAMINATION TRAY	
1	Enamel tray	1
2	Torch	1
3	Sterile gloves	1
4	Stethoscope	1
5	Tuning fork	1
6	Reflex hammer	1
7	Measuring tape	2
8	Test tubes	1
9	Tongue Depressor	1
10	Proctoscope	1
11	Nasal Speculum	1
12	Snellens hart (Marathi+English)	1
13	Otoscope with 10 ear speculum+2 batteries	1
14	Ophthalmoscope with 2 batteries	1
15	Otoscope+Ophthalmoscope set	1
16	BMI	4
17	Pen lights	1
18	Bowl	1
19	Head light wire	1
20	Head mirror	1
21	Old ear speculum set	1
	HOT AND COLD APPLICATION TRAY	
1	Plastic tray	1
2	Ice cap	3
3	Hot water bag	1
4	Electric hot water bag	1
	VITAL SIGNS TRAY	
1	Pulse time teaching Stethoscope	2
2	Stethoscope + Temperature and humidity meter	1
3	Sphygmomanometer	2
	VITAL SIGNS TRAY	
1	Enamel Tray	1
2	Stethoscope	1
3	Sphygmomanometer	1



Principal
Bel-Air College of Nursing
Panchgani - 412805

4	Glass Thermometer	1
5	Digital Thermometer	1
6	Mini digital Thermometer	1
7	Wrist BP Monitor	1
8	Temporal touch Thermometer	1
9	Blood glucose	1
10	Glass Bottles	2
11	Plastic Bottles	2
12	Steel Bowl	2
13	Kidney Tray	3
14	Pulse Oxymeter	1
	BED BATH TRAY	1
1	Enamel Tray	2
2	Plastic Bucket	1
3	Mug	1
4	Soap dish	1
5	Brush	2
6	Nail cutter	3
7	Comb	1
8	Feeding cup	1
9	Oil	1
10	Powder	1
11	Vaseline	1
12	Kmno ⁴ bottle	2
13	Sponge cloth	1
14	Mackintosh	1
15	Towel	1
16	Kidney Tray	1
17	Bowl	2
18	Toothpaste/Toothbrush	1\1
	SPECIMEN COLLECTION	1
1	Enamel Tray	1
2	Mackintosh	1
3	EDTA bulb (purple)	1
4	Sodium citrate bulb (Blue)	1
5	Plain bulb (Red)	1
6	Sputum bottle (AFB)	1
7	Urine bottle	1
8	Stool bottle	3
9	Falcum tube (MDR)	
10	Bactec bottle	
	ENEMA TRAY	
1	Enamel Tray	1
2	Plastic Enema can with Tubing	1

3	Steel Enema can with Tubing *	1
4	Artery Forcep	1
5	Soap Dish	1
6	Measuring Jar (250ml)	1
7	Funnel (Big and Small)	1
8	Cleansing Enema Set	1
9	Steel Bowl	1
10	Towel	1
11	Mackintosh	1
	CVP TRAY	1
1	Plastic Tray	1
2	Sterile gloves	1
3	Arrow CVC set	4
4	Guide wire	1
5	Femoral line	1
6	Radial Artery Compressor device	
		1
	PERSONAL PROTECTIVE EQUIPMENT (PPE) TRAY	7
1	Plastic Tray	2
2	Goggles	1
3	Disposable cap	2
4	Disposable mask	1
5	Disposable gown	2
6	Disposable gloves	1
7	Shoe cover	2
8	N95 mask	1
9	Surgical Drape	1
10	Sterile gloves	1
11	Face shield	1
	STEAM INHALATION TRAY	
1	Plastic tray	1
2	Nelsons steam inhaler	1
3	Enamel bowl (big)	1
4	Sputum mug	1
5	Spirometer	1
6	Steel bowl	1
7	Towel	1
8	Kidney tray	1
	OXYGENATION TRAY	
1	Plastic tray	1
2	Nasal Cannula	1
3	Nebulizer with mouth piece	1
4	Adult multivent mask	1
5	Pediatric O ² mask	1



Principal

**Bel-Air College of Nursing
Panchgani - 412805**

6	T-piece (T-oxygenator)	1
7	Spirometer	1
8	Airway number-03	1
9	Metered dose Inhaler (MDI)	1
	EMERGENCY TRAY	
1	Plastic tray	1
2	Laryngoscope (l) with battery+Blades (3)	6
3	Endotracheal Tube	1
4	AMBU bag with mask	1
5	Oral airway (1/2/3/4) each one	1
6	Magills Forcep	1
7	Tracheostomy Tube	1
8	Plastic mask	1
9	Suction catheter	
	IV INFUSION TRAY	
1	Enamel Tray	2
2	IV cannula	2
3	Bivalve (3way)	1
4	Scalp vein set	1
5	10 cm extension	1
6	Closed IV Catheter	1
7	IV set (macroset)	1
8	Blood set	1
9	10cc syringe	1
10	Sterile gloves	1
11	Iv cannula Fixator	1
12	Tega derm	1
13	Transpore	1
14	Sticking plaster (Cotton)	4
15	Tourniquet	1
16	Venatech IV Trainer	
	CATHETERIZATION TRAY	1
1	Plastic Tray	5
2	Foleys catheter (10/12/14/20/22) each 1	2
3	Silicon catheter (14/18)	1
4	Urosac bag	1
5	Towel	1
6	Mackintosh	1
7	Kidney Tray	1
8	Gloves	1
9	10cc Syringe	1
10	U-drain	1
11	Lignocaine Jelly	

	URINE TESTING TRAY	
1	Plastic Tray	1
2	Test Tube stand	10
3	Test Tubes	3
4	Test Tube Holder	1
5	Spirit Lamp	4
6	Droppers	1
7	Benedict Solution	1
8	Acetic Acid	1
9	Nitric Acid	2
10	Sample Bottles	1
11	Litmus paper (Pink/Blue)	1
12	Gloves	1
13	Match Box	1
14	Kidney Tray (Steel)	1
15	Lactometer	1
16	Test Tube Cleaner	
	COMFORT DEVICES	1
1	Plastic Tray	1
2	Air Cushion	1
3	Sand Bags	2
4	Cotton Rings	2
5	Foot Blocks	
	BANDAGES	1
1	Plastic Tray	4
2	Splints	10
3	Triangular Bandage	2
4	Many Tailed Bandage	2
5	Crep Bandage	1
6	Readymade Sling	1
7	Collar Bandage	1
8	Gauze Bandage	1
9	Cotton Bandage (10-15 cm)	1
10	Cotton bandage (7-8 cm)	3
11	Cotton Bandage (5 cm)	2
12	Finger Bandage (1-2 cm)	1
13	Finger Splint	2
14	Padded Knee Caps	1
15	T-bandage	2
16	Four Tailed bandage	2
17	Eye Bandage	
		1
	Extra Tubings Tray (Enamel)	
	NG TUBE TRAY	1

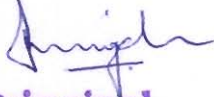
Principal
Bel-Air College of Nursing
Panchgani - 412805

1	Plastic Tray	1
2	Ryles Tube (14/15)	1
3	50cc Syringe	1
4	5cc Syringe	1
5	Micropore Sticking	1
6	Bowl	1
7	Lignocaine Jelly	1
8	Kidney Tray	1
9	Towel	1
10	Mackintosh	1
11	Glass, Spoon	2
12	Glass (steel)	16
13	Bowl (steel)	5
14	Urometer jar (Glass)	2
15	Mortar and Pestle (Ceramic)	1
16	Mortar and Pestle (steel)	1
17	Syringe tray (small)	1
18	Steel tray with lid	
	STEEL TRAY WITH LID (DRESSING)	1
1	Bowl	1
2	Artery Forcep	1
3	Thumb Forcep	1
4	Scissors	
	STEEL TRAY WITH LID	8
1	Droppers	4
2	Finger Splint	3
3	Measuring Tape	3
4	Metal Tracheostomy	1
5	Inner Cannula	4
6	Test Tube Holder	
	STEEL TRAY WITH LID	1
1	Vaginal Speculum	1
2	Sims Speculum	2
3	Tuning Fork	2
4	Percussion hammer	4
5	Plain Thumb Forceps	2
6	Toothed Thumb Forceps	1
7	Straight artery Forceps	2
8	Curved artery Forceps	3
9	Needle Holder	1
10	Curved Scissor	1
11	Kochers Forceps	1
12	Magills Forceps	2
13	Scalpel (BP handle)	2

14	Tongue Depressor	2
15	Straight Scissor	2
16	Spatula	2
17	Cheatle Forceps	8
18	Nasal Speculum	
		5
1	Steel Kidney Tray (Small)	10
2	Plastic Kidney Tray (Small)	6
3	Plastic Kidney Tray (Medium)	2
4	Plastic Kidney Tray (Big)	2
5	Feeding Cup	5
6	Sputum Cup	4
7	Urine Testing bottle	3
8	Ounce glass (plastic)- 125 ml	2
9	Ounce glass (Plastic)- 90 ml	1
10	Ounce glass (Plastic)- 60 ml	4
11	Ounce glass (Plastic)- 50 ml	5
12	Ounce glass (plastic)- 25 ml	2
13	Ounce glass (Glass)- 150 ml	
14	Measuring Cup (plastic)- 1000 ml	
		2
1	Bed Pan	4
2	Urinal	3
3	Nelson Inhaler	1
4	Enamel bowl (Big)	1
5	Enamel Jug	2
6	First Aid Bag	2
7	Soap Dispensor stands	1
8	Traction Set	
		1
1	Steel Drum	6
2	Gamjee Packets	20
3	Surgical Drape	4
4	Sterile gloves	1
5	Non Sterile gloves box	2
6	Cotton Ball Packets	2
7	Surgical Apron	1 Box
8	Alcohol Pre-pads	2
9	Adhesive Plastic	1 packet
10	Disposable Mask	2 packs
11	PPE Apron kit	
	NEEDLE TRAY	
1	Glass Syringe	1
2	Insulin Syringe	1
3	BCG Syringe	1 each
4	Spinal Needle (21/22/23/26/27)	1 each

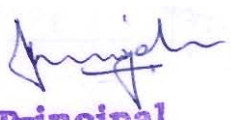
Principal
Bel-Air College of Nursing
Panchgani - 412805

5	Scalp Vein Set (22/23/24)	1 each
6	IV Cannula (24/22/20/18/16)	1
7	Metal Needle	1 each
8	Needles (20/21/22/24/26/27)	1
9	Needle Burner	1
10	Needle Cutter	1
11	Scissor	1
12	Tray containing extra needles and suture materials	1
	IV FLUID	1
1	NS- 500ml	1
2	RL-500ml	1
3	D10-500ml	2
4	D5-500ml	2
5	Mannitol-100ml	1
6	NS-500ml	
7	DNS-500ml	
	ENAMEL TRAY-1	2
356	Asepto Syringe	3
357	Corrugate Drain Sheet	1
358	Colostomy Bag	1
359	Slide Box	1
360	Slide Cover Box	1
361	ECG Leads	5
362	Blue Litmus Paper	4
363	Glass Syringe	2
364	Plastic Syringe	1
	ENAMEL TRAY-2	
1	Betadine solution	2
2	Savlon Solution	1
3	Nitric Acid	1
4	Hydrogen Peroxide	1
5	Boric Acid Powder	1
6	Sodium Bicarbonate	1
7	Methyl Spirit	2
8	Dettol Solution	1
9	Liquid Paraffin	1
10	Betadine Ointment	2
11	Medications-Tablet/Ampule/Syrups/Vials	1
12	Lignocaine gel	
13	Sanitizer Bottle	6
		2
1	Basins	1
2	Big Bucket	9
3	Medium Bucket	1

4	Small Bucket	
5	Mug	
	FON LAB ARTICLES	
1	CPR Manikin (Old)	1
2	Multifunction Patient Care	2
3	Ostomy Care Dummy	1
4	IV Cannulation Hand	1
5	CPR Manikin (New)	1
6	Simulation manikin (Annie)	1
7	Adult airway and CPR Trainer (Alwin)	2
8	Cholelithiasis	1
9	Liver Cirrhosis	1
10	Peptic Ulcer	1
11	Pancreatitis	1
12	Cardiac monitor	1
13	ECG Cable	1
14	SPO ₂ Cable with Probe	1
15	NIBP Cable with Cuff	1
	BIOMEDICAL WASTE BINS	
1	Red/Blue/Black/Yellow	1
2	Beds	11
3	Lockers	18
4	Mattress	11
5	Pillows	8
6	Stool	4
7	Wooden Cupboard	1
8	Godrej Cupboard	1
9	Steel Trolley	1
10	Cardiac Table	1
11	Wheel Chair	1
12	Screen	1
13	IV Stand	2
	MODELS	
1	Stages of bedsore	1
2	Angioplasty model	1
3	Suturing Technique	1
4	Cholelithiasis	1
5	Liver Cirrhosis	1
6	Peptic Ulcer	1
7	Pancreatitis	1
8	Physiology of pain	1
9	Maslow's Hierarchy	1
10	Chain of infection	1
11	Intensive care unit	1

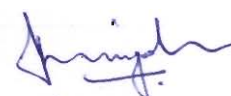

Principal
 Bel-Air College of Nursing
 Panchgani - 412805

12	Blood Group- Donar And Recipient	1
13	Subcutaneous- Injection	1
14	Intradermal- Injection	1
15	Vastus Lateralis Site	1
16	Dorsogluteal Site	1
	CHARTS	
1	Transport of Injured	1
2	Unconsciousness	1
3	Hand Washing Technique	1
4	Electric Shock and Management	1
5	Removal of Foreign Body	1
	LINEN CUPBOARD	
1	Bed Sheet-	
2	Blue	20
3	Pink	17
4	White	34
5	Multicolour	6
6	Drawsheets	12
7	Pillow Cover-	
8	Blue	10
9	Pink	17
10	White	20
11	Blankets	7
12	Towels-	
13	Big	8
14	Small	3
15	Sponge Cloths	32
16	OT Dress (Shirt+Pants)	8 Pairs
17	OT Slippers	3
18	Green Gown	6
19	Dummy Shirts	4
20	Dummy Pant	2
21	White Apron	2
22	Pink Gown	1
23	Rain Coat	1
24	Mackintosh Roll (Big)-3, Small-3, Medium-9	15
25	Male Genitalia (Wooden Cupboard)	2
26	Blue Bin (Big)	1
27	Towel-	
28	Blue	2
29	Blue+White	1
30	Electric kettle	1
	EXTRA INSTRUMENTS	
1	Tongue holding forcep	1

2	Straight artery forcep	1
3	Freer skin hook	1
4	Mathieu needle holder	1
5	Snook hook	1
6	Deschamps ligature needle	1
7	Doyeer tongue depressor	1
8	Sims uterine curettage	1
9	Cartilage clamp	1
10	Satinsky clamp	1
11	Degerine reflex hammer	1
12	Tudor Edwards scapula retraction	1
13	Protoscope	1
14	Eteel protector	1
15	Scissors	1
16	Spatula	1
17	Bone drill	1
18	Axe	1
19	Mallet hammer	1
20	Filter drip	1
21	Two finger glass syringe	1
22	c. shaped retractor	1
23	Horsley bone cutting forceps	1
24	Curved bone file	1
25	Scalpel	1
26	Vulsellum forceps	1
27	Teat knife	1
28	Dissecting instruments	1

Principal
Bel-Air College of Nursing
Panchgani - 412805



BEL-AIR COLLEGE OF NURSING, PANCHGANI.

COMMUNITY HEALTH NURSING

LIST OF THE LABORATORY INVENTORY

S.N	ARTICLES	QUANTITY
1	Test tube (small)	19
2	Specimen bottle –Urine (glass)	47
3	Test tube (big)	45
4	Spirit lamp (steel)	01
5	Spirit lamp (aluminum)	19
6	Spirit lamp (glass)	09
7	Soap dish (big)	22
8	Soap dish (small)	08
9	Hand scrubber (brush)	16
10	Puppets (big)	10
11	Puppets (small)	07
12	Puppets (cardboard)	10
13	Puppet (string)	05
14	Contraceptives devices	
	a. Mala N tablets	06
	b. Copper T	10
	c. Condom (Male)	27
	d. Condom (Female)	02
	e. Extra Lubricants (white and blue)	08
15.	Ponds powder	02
16.	Hand Sanitizer	01
17.	Alcohol swab	74
18.	Weighing Machine	02
19.	First Aid Bag	
	a. Tourniquet	01
	b. Kidney tray	01
29	Ounce glass (25ml)	28
30	Ounce glass (50ml)	05
31	Ounce glass (150ml)	13
32	Fetoscope (aluminum)	18
33	Fetoscope (plastic)	01
34	Steel Bowl (small)	55
35	Steel Bowl (medium)	34
36	Kidney tray (Plastic)	29
37	Clinical thermometer	19
38	Thumb forceps (medium)	35
39	Artery forceps (straight)	55
40	Artery forceps (Curved)	05
41	Nail cutter	13
42	Dropper (plastic)	11

Principal
Bel-Air College of Nursing
Panchgani - 412805

43	Dropper (rubber)	23
44	Artery forceps (aluminium)	16
45	Artery forceps (steel)	60
46	Scissors (straight)	65
47	Scissors (curved)	21
48	Hammer	03
49	Solution bottles (500ml)	
	a. Savlon Solution	01
	b. Betadine Solution	01
	c. Benedict Solution	01
	d. Hydrogen peroxide Solution	02
	e. Hydrochloric acid Solution	01
	f. Nitric acid Solution	01
	g. Hand-wash (Dettol) Solution	01
	h. Spirit Solution	03
	i. Sterilium Solution	01
50	Test tube holder	20
51	Cotton Material	01
52	Audio Visual Aids	
	a. Charts	30
	b. Flash Cards	12
53	Community Bags	45
54	Sahli's Hemometer	05
55	Stethoscope	04
56	B P Apparatus (automatic)	01
57	Glucometer with strips	01
58	Surgical blades	60
59	Reagent Strips (urine)	01
60	Syringe (20ml)	01
61	Syringe (Auto-disable)	02
62	Specimen bottle (stool)	06
63	Mackintosh sheet	47
67	Hand towel	07
68	Cotton pack (blue)	74
69	Community Map	09
70	Community Model	09
71	Furniture	
	a. Table	05
	b. Chairs	17
	c. Wooden benches	04
	d. Cot with mattress	01

Shriyach

INDIAN RED CROSS SOCIETY
 BEL-AIR COLLEGE OF NURSING PANCHGANI
 ANATOMY / PRECLINICALS LAB INVENTORY

Serial Number	Name of the Article	Quantity
1.	Life Size Skeleton	1
2.	Femur Bone	2
3.	Humerus Bone	2
4.	Ulna	2
5.	Tibia	2
6.	Fibula	2
7.	Clavicle	2
8.	Skull	1
9.	Sacrum	1
10.	Innominate Bone	2
11.	Ribs	12
12.	Rib Model with Xiphoid	1
13.	Set of Bones Hand	1 set
14.	Set of Bones Feet	1 set
15.	Knee Joint	1
16.	Shoulder Joint	1
17.	Radius Bone	2
18.	Hip Joint	1
19.	Elbow Joint	1
20.	Patella	2
21.	Carpel	8
22.	Unisex Tarsal Bones 25	1 set
23.	A Set Of Phalanges 18	1 set
24.	Teeth Molar	3
25.	Scapula Bones	2
26.	Male Pelvic Organ	1
27.	Anatomy of Kidney Frame	1
28.	Male Genitourinary Frame	2
29.	Giant Dental Care Model	2
30.	Female Urogenital System	2
31.	Tongue	1
32.	Lower Jaw Model	1
33.	Stages of TB	1 set
34.	Giant Eye Model	1
35.	Heart Model	1
36.	Brain Model with Artery	1
37.	Giant Ear Model	2

Principal

Bel-Air College of Nursing
 Panchgani - 412805

38.	Enlarged Skin Model	1
39.	Handmade Brain	1
40.	Larynx, Heart ,Lung Model	1
41.	Microscope	1
42.	Magnified Larynx Model	1
43.	Human Kidney with Adrenal Gland	1
44.	A Lung Model	1
45.	A Big Human Model	1
46.	A Big Human Model with CNS Respiratory	1
47.	A Cut section of Lung	1
48.	A Cut section of Skin with Model of Papule and Pustules	1
49.	A Model of Human Mouth	1
50.	A Set of Breast with Ca Breast	1 set
51.	A Set of Vertebra (25 Parts)	25
	OHP TRANSPARNCIES	
52.	HIV virus	1
53.	Birth of a baby	1
54.	Human muscular system	1
55.	Growth and development	1
56.	Section of human skin with hair	1
57.	Sperm structure	1
58.	Developing ovum	1
59.	Female reproductive system	1
60.	Menstrual cycle	1
61.	Human retina	1
62.	Mammary gland	1
63.	Blood cell	1
64.	Structure of ear	1
65.	Structure of human heart	1
66.	Human eye	1
67.	Longitudinal section of bones	1

68.	Human tooth	1
69.	Excretory system	1
70.	Types of teeth	1
71.	Human brain and cranial system	1
72.	Human circulatory system	1
73.	Spinal cord structure	1
74.	Nervous system	1
75.	Chambers of ruminant stomach	1
76.	Vestigial structure	1
77.	Ultra filtration method	1
78.	Action of hormones	1
79.	Human muscular system	1
80.	Pituitary gland	1
81.	Lymphatic system	1
82.	Testis and seminiferous tubules	1
83.	Uterus with fetus	1
84.	Reflex arch	1
85.	Thyroid and its associated structure	1
86.	Human endocrine glands	1
87.	Liver and pancreas	1
88.	Knee joint	1
89.	Human mouth	1
90.	Human spine	1
91.	Shoulder joint	1

Principal

Principal

**Bel-Air College of Nursing
Panchgani - 412805**

92.	Wrist joint	1
93.	Elbow joint	1
94.	Hip joint	1
95.	Foot and toe joint	1
96.	Alveoli	1
97.	Structure of face	1
98.	Human Respiratory System	1
99.	Human Nervous System	1
100.	Autonomic Nervous System	1
101.	Human Skeleton	1
102.	Human Male Reproductive System	1
	CHARTS	
103.	Respiratory system	1
104.	Endocrine system	1
105.	Lymphatic system	1
106.	Skeletal system	1
107.	Human heart system	1
108.	Human eye system	1
109.	Human ear system	1
110.	Kidney, skin , excretory system	1
111.	Genitourinary system	1
112.	Renal model	1
	THERMAL CHARTS	
113.	Function of brain	1

114.	Ulcerative colitis	1
115.	Hemodialysis	1
116.	Primary union	1
117.	Stem cell transplantation	1
118.	Congenital heart disease	1
119.	Trachea-esophageal fistulas	1
120.	Mitosis and meiosis	1
121.	Exercise of heart	1
122.	Stages of wound healing	1
123.	Renal transplantation	1
124.	Normal neuron	1
125.	Types of fracture	1
126.	Stages of concept of bronchopulmonary segments	1
127.	Sites of spinal anesthesia	1
128.	Pulmonary TB	1
	SPECIMEN	
129.	Mrs. Saritha : Spleen	1
130.	Mrs. Urmila Uday: Fibroid	1
131.	Mr. Ganesh Mahadev: IBD	1
132.	Mr. Shaileesh : Traumatic Spleen	1
133.	Resected bowel	1
134.	Carcinoma of stomach	1
135.	Intestinal obstruction	1
136.	Appendix	1
137.	Renal calculus	1
138.	Empty specimen bottle small	26
139.	Empty specimen bottle small	4

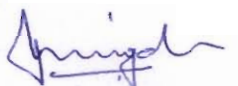
Principal
 Bel-Air College of Nursing
 Panchgani - 412805

Indian Red Cross Society

BEL-AIR COLLEGE OF NURSING, PANCHGANI

COMPUTER LAB

LIST OF ARTICLES

Sr. No	Name of Articles	Quantity
1.	Monitors	15
2.	CPU	15
3.	Keyboard attached with Monitor	15
4.	Extra Keyboard	2
5.	Mouse	15
6.	Chairs	20
7.	Camera	2
8.	Headphone	1
9.	Monitor Cover	15
10.	Keyboard Cover	17
11.	Glass Table	1
12.	Switch Board	25
13.	Speaker	3

Principal
Bel-Air College of Nursing
Panchgani - 412805

BEL-AIR COLLEGE OF NURSING, PANCHGANI.

LIST OF INVENTORY FOR THE NUTRITION LABORATORY

SR.NO	ARTICLES	QUANTITY
1	Silver Plastic Tray	1
2	Wooden Tray	1
3	Wine Glass	5
4	Long Glass	1
5	Small Glass	18
6	Ice-cream Glass	5
7	Long Juice glass	19
8	<u>Dinner Set</u>	
	Spoon small	2
	Spoon big	3
	Serving bowl	3
	Tray(Oval Plate)	1
	Small dish	5
	Big dish	5
		16
9	Soup bowl	20
10	Soup spoon	16
11	Glass bowl	6
12	Serving bowl set big	2
13	Serving bowl set small	14
14	Butter plate with lid	2
15	Saucer	22
16	Copper plate	1
17	Aarati plate	1
18	Small copper plate	2
19	Brass big Samayi	1
20	Silver small Samayi	1
21	Sprinkler silver	1
22	Silver Basket	1
23	Ordinary basket	1
24	Plastic Bowls	17
25	Flask Steel	4
26	Flask plastic	1
27	Golden ring cup	6
28	Flower printed cup with saucer	12
29	Printed cup	11
30	Golden printed cup	6
31	Soup cup set	1
32	Golden printed saucer	8
33	Shoe shaped glass	2
34	Coffee cup	12
35	Dry fruit tray	1
36	Spoon stand	4
37	Glass jar	3

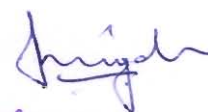

Principal
Bel-Air College of Nursing
Panchgani - 412805

87	Chocolate mould	1
88	Fiber spoon	12
89	Fiber saucers	28
90	White flower big cups	2
91	Wide cup	1
92	Sandwich tray big	2
93	Sandwich tray small	5
94	Attached bowls	1
95	Fiber big tray	2
96	Fiber oval tray	8
97	Glass oval tray	2
98	Potato peeler	1

Principal
Bel-Air College of Nursing
Panchgani - 412805

INDIAN RED CROSS SOCIETY
BEL AIR COLLEGE OF NURSING, PANCHGANI
OBSTETRICS AND GYNACOLOGY LAB INVENTORY

SR. NO	INVENTORY	COUNT
A.	MODELS	
1.	Fetal development	9
2.	Female pelvis	4
3.	Fetal skull	2
4.	Dummy with placenta	3
5.	Fetal dummies	3
B.	INSTRUMENTS	
1.	Mucus sucker	2
2.	Cord clamp	14
3.	Cusco's speculum (steel)	--
4.	Cusco's speculum (plastic)	1
5.	Female catheter plastic	6
6.	Kocher's forceps	2
7.	Needle holder	2
8.	Breast pump	2
9.	Toothed dissecting forceps	1
10.	Thumb forceps	2
11.	Suture removal scissor	1
12.	Allis forceps	2
13.	Valsellum	2
14.	Paediatric stethoscope	1
15.	Fetoscope	2
16.	Sim's speculum	--
17.	Hegar's dilator	9
18.	Uterine sound	1
19.	Sponge holding forceps	2
20.	Scissor	1
21.	Chittle forceps	3
22.	Ovum forceps	1

[Signature]
Principal
 Bel-Air College of Nursing
 Panchgani - 412805

6.	Hepatitis B	1
	Others	
1.	Dinoprostone gel	1
2.	Copper T	1
3.	Suture material (Absorbable)	10
4.	Suture material (non-absorbable)	10
5.	Condom female	--
6.	Condom male	8
7.	Syringe	1
	Solutions	
1.	Normal saline	--
2.	Betadine solution	--
3.	Spirit	--
D.	SPECIMENS	
1.	12-16 weeks foetus	1
2.	13 weeks foetus	1
3.	Uterus	3
4.	Placenta	--
5.	Ovarian cyst	1
6.	20 weeks foetus	1
7.	Fibroid uterus	1
8.	Breast lump	1
9.	Ectopic pregnancy	1
10.	Foetus with placenta	1
11.	Hydrocephalus	1
12.	Baby with spina bifida	1
13.	Anencephaly	1
14.	Neural tube defect	1
15.	Bulky uterus with fibroid and placenta	1
E.	MODLES / POSTERS	
1.	Varieties of cephalic presentations in different attitude	1
2.	Level of fundus according to gestational week	1
3.	Physiology of lactation	1
4.	Methods of placental separation	1

Principal
 Bel-Air College of Nursing
 Panchgani - 412805

गाव नमुना सात
अधिकार अभिलेख पत्रक
[महाराष्ट्र जमीन महसूल अधिकार अभिलेख आणि नोंदवह्या (तयार करणे व सुस्थितीत ठेवणे) नियम, १९७१ यातील नियम ३,५,६ आणि ७]
तालुका :- सातारा

गाव :- पांचगणी
गट क्रमांक व उपविभाग : 79/1

गट क्रमांक व उपविभाग	भू-धारणा पध्दती	भोगवटदार वर्ग-1	भोगवटदाराचे नांव
79/1	डी व्हार विलीमोरीअ	डी व्हार विलीमोरीअ	डी व्हार विलीमोरीअ
शेवते स्थानिक नांव :-	ह.आर.नो.मी	ह.आर.नो.मी	ह.आर.नो.मी
क्षेत्र एकक	1.04.00	1.04.00	1.04.00
निरावत	-	-	-
बागायत	-	-	-
तरी	-	-	-
वरकस	-	-	-
इतर	-	-	-
एकूण क्षेत्र	1.04.00	1.04.00	1.04.00
घाट-खराब (लागवडीस अयोग्य)	0.05.00	0.05.00	0.05.00
वर्ग (अ)	-	-	-
वर्ग (ब)	0.05.00	0.05.00	0.05.00
एकूण घाट	1.37	1.37	1.37
आकारणी	-	-	-
जुडी किंवा विशेष	-	-	-
आकारणी	-	-	-
मुन फेरफार क्र. (1019),(1926),(3053),(3084)			

सुचना : या संकेतस्थळावर दर्शविलेली माहिती ही कोणत्याही शासकीय अथवा कायदेशीर बाबीसाठी वापरता येणार नाही.

गाव नमुना बारा
पिकाची नोंदवह्या
[महाराष्ट्र जमीन महसूल अधिकार अभिलेख आणि नोंदवह्या (तयार करणे व सुस्थितीत ठेवणे) नियम, १९७१ यातील नियम २९]
तालुका :- सातारा

गाव :- पांचगणी
गट क्रमांक व उपविभाग : 79/1

वर्ष	हंगाम	मिश्रणाचा संकेत क्रमांक	पिकाबाबतील क्षेत्राचा उपशील				निर्मळ पिकाबाबतील क्षेत्र				लागवडीसाठी उपलब्ध नसलेली जमीन	जल सिंचनाचे साधन	शेत	
			मिश्र पिकाबाबतील क्षेत्र		घटक पिके व प्रत्येकाबाबतील क्षेत्र		निर्मळ पिकाबाबतील क्षेत्र		स्वरूप	क्षेत्र				
			जल सिंचित	अजल सिंचित	पिकांचे नाव	जल सिंचित	अजल सिंचित	पिकांचे नाव						जल सिंचित
(१)	(२)	(३)	(४)	(५)	(६)	(७)	(८)	(९)	(१०)	(११)	(१२)	(१३)	(१४)	(१५)
2018-19	संपूर्ण वर्ष		ह.आर. नो.मी	ह.आर. नो.मी	ह.आर. नो.मी	ह.आर. नो.मी	ह.आर. नो.मी	ह.आर. नो.मी	ह.आर. नो.मी	ह.आर. नो.मी	ह.आर. नो.मी	ह.आर. नो.मी	ह.आर. नो.मी	ह.आर. नो.मी
														गवत पट्ट 1.0400

सुचना : या संकेतस्थळावर दर्शविलेली माहिती ही कोणत्याही शासकीय अथवा कायदेशीर बाबीसाठी वापरता येणार नाही.

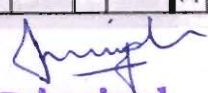
Principal

REFERRED PLAN

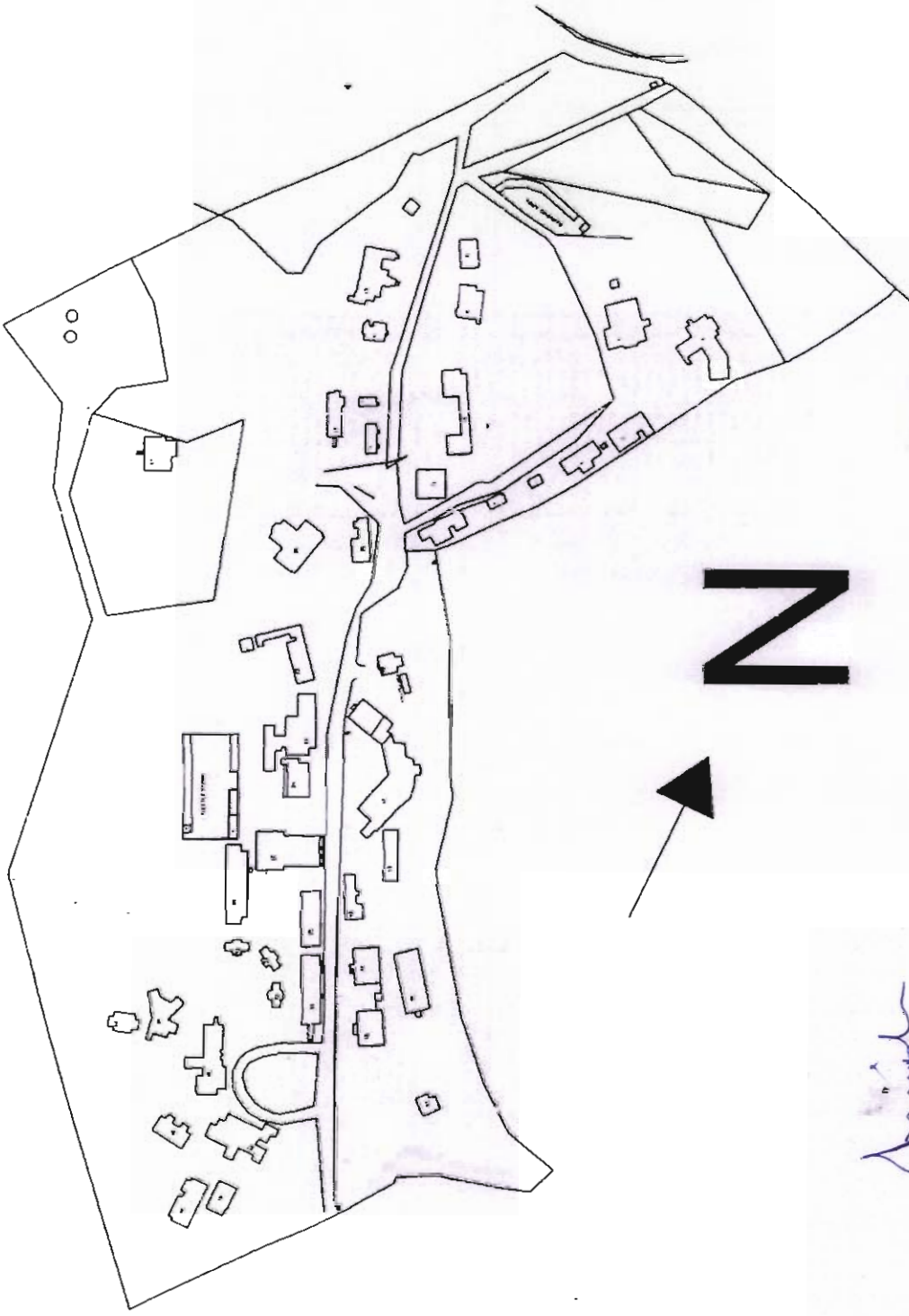

NO.	DESCRIPTION	AREA (SQ. FT.)	PERCENTAGE OF TOTAL AREA
1	EXISTING BUILDING	10007.50	100.00%
2	LANDSCAPE	10007.50	100.00%
3	ROADS	10007.50	100.00%
4	OPEN SPACES	10007.50	100.00%
5
6
7
8
9
10
11
12
13
14
15
16
17
18
19
20
21
22
23
24
25
26
27
28
29
30
31
32
33
34
35
36
37
38
39
40
41
42
43
44
45
46
47
48
49
50
51
52
53
54
55
56
57
58
59
60
61
62
63
64
65
66
67
68
69
70
71
72
73
74
75
76
77
78
79
80
81
82
83
84
85
86
87
88
89
90
91
92
93
94
95
96
97
98
99
100

TOTAL AREA OF EXISTING BUILDING 10007.50 SQ. FT.
 TOTAL AREA OF THE LAND 10007.50 SQ. FT.
 PERMISSIBLE FSI 12.25%
 REMAINING FSI 2.17%
 REMAINING AREA AS PER FSI 21000.00 SQ. FT.

SITE PLAN OF THE PROPERTY
 OF THE BEL-AIR SANATORIUM
 AT
 PANCHGANI

[Signature]
Principal
 Bel-Air College of Nursing
 Panchgani - 412805

t. 431.56
 ANURVEDIK
 CENTER

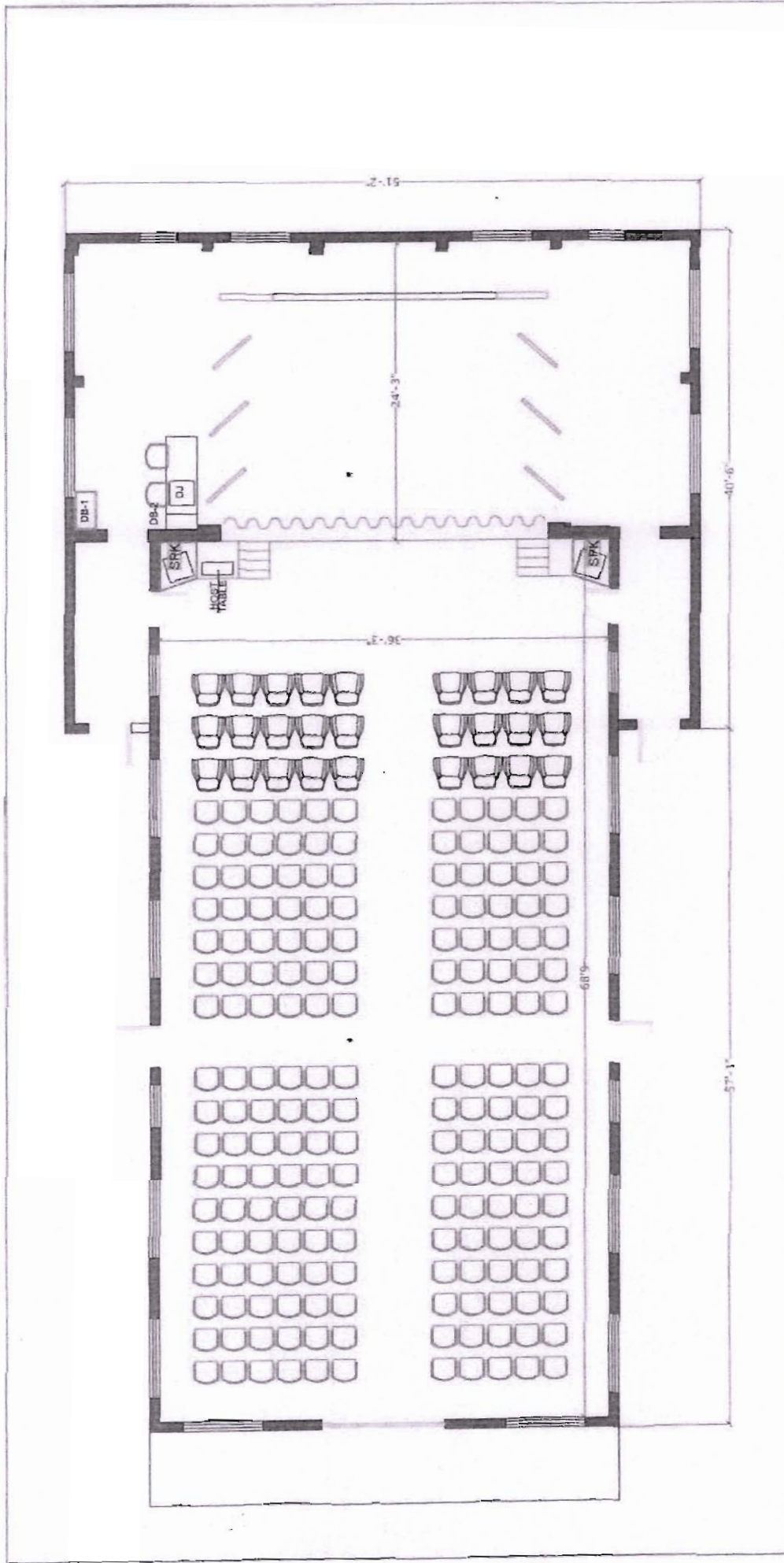

PROJECT:-

AUDITORIUM
at Bel Air-hospital,
pachgani

TITLE :-

GROUND FLOOR PLAN

NOTE :-

SCALE - NTS

DWG NO- 01

DATE -

NORTH -

Atwat
ER.ABDUL TAWAF KHAN
B.E CIVIL (MU)

Principal

Principal
Bel-Air College of Nursing
Panchgani - 412805

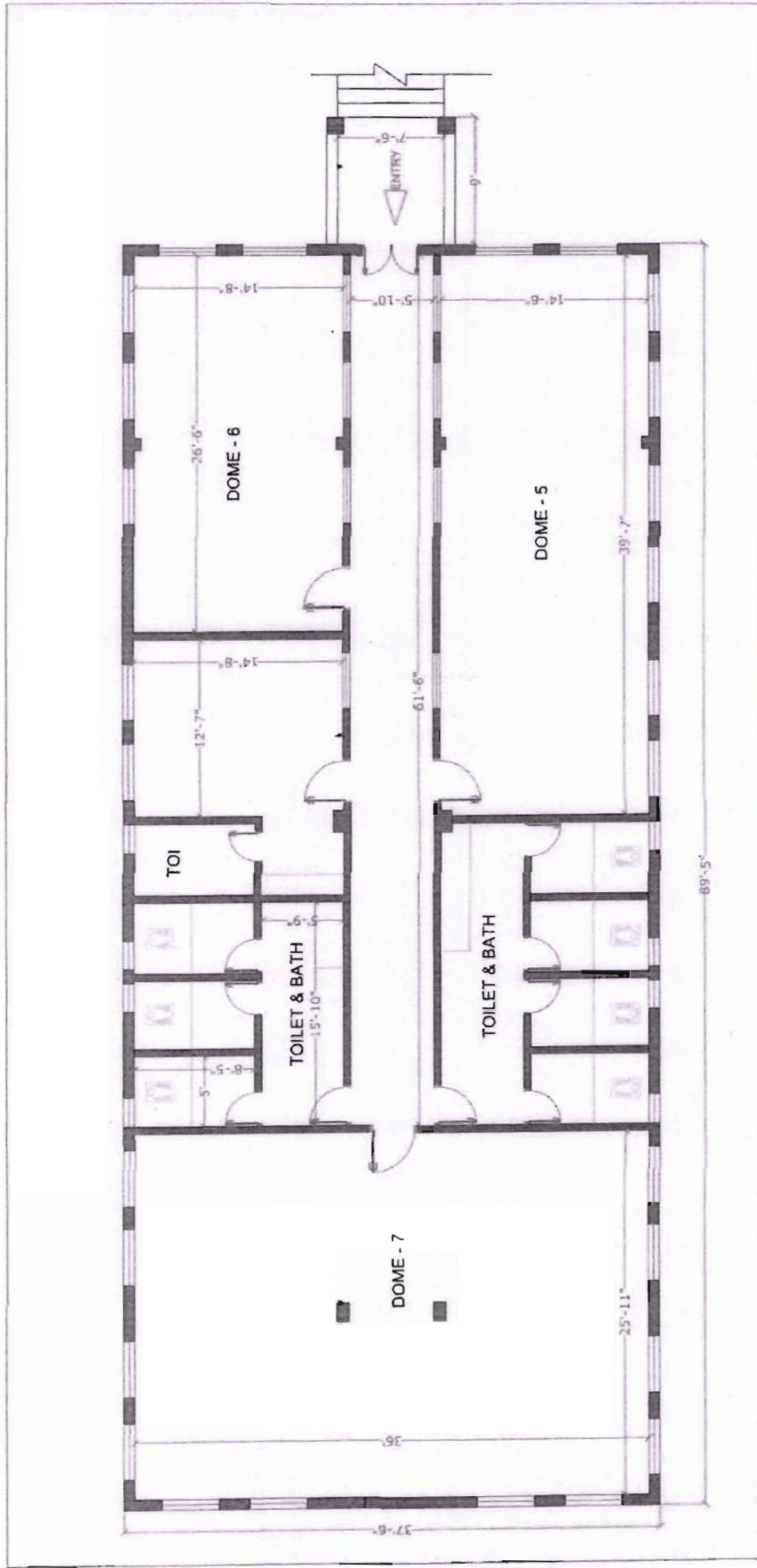

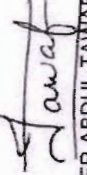
PROJECT:- ERBA HOSTEL at Bel Air-hospital, pachgani	TITLE :- GROUND FLOOR PLAN	NOTE :-	SCALE - NTS DWG NO- 01 DATE - NORTH -	 ER. ABDUL TAWAF KHAN B.E CIVIL (MU)
---	--------------------------------------	---------	--	---

Principal
 Bel Air College of Nursing
 Pachgani - 412805

NIN Certificate No.: NIN/MH/BSR/PCGN/006-H.

Document No :- F/CC/03/02
Rev. Date :- 25/02/2010

Association of Hospital Owner's, Satara (Reg. No. 6168)



Nature In Need, BMWT Services

(Undertaking)

CBWTSDF, Satara

(Reg. No. MPCB/ZO (PAMS) / BMW - Pune - 37/2010)

MEMBERSHIP CERTIFICATE.

Name of Doctor / Director : Dr. fr. Tomy K.

Name of Institute : BEL - Air Hospital

Type of Institute : Hospital

Address / Location : AT Post - Panchgani, TAL - Maharashtra

Date of Joining : _____

Validity From : 9th April 2023 to 31st March 2024

Cerify that above mention Doctor & Institute has been joined to "Nature In Need" BMWT Services, CBWTSDF, Satara for Collection, Transport & Disposal of Bio-Medical Waste on Yearly basis.

Signature

(Dr. U V Athavale)
AHO President

Signature

(Dr. Jayant Gaikwad)
AHO Secretary

NATURE IN NEED
Nature in Need
Services

Project :- S. No. 83, At./ Post - Sohgaon, Tal. & Dist. Satara. (Reg. No. 326, Dated : 1/08/2005)
Office :- 1138/A, Shree Gurukrupa Apartment, Near Adalatwada, Shaniwar Peth, Satara - 415 002.
Mobile :- 8007775800, 8007775791 to 98.

Principal



सत्यमेव जयते

S.K.N.P GENERAL HOSPITAL, SATARA.

HEALTH DEPARTMENT
FORM C

Certificate of registration Section 5 of the
Bombay Nursing Homes Registration Act 1949

Certificate

No.: SAT / PCH / 01

This is to certify that Shri. / Smt. Director, Bel Air Hospital
has been registered under the Bombay Nursing Homes Registration Act 1949 in
Respect of BEL AIR HOSPITAL
situated at ALP Pachgani Tal. Mahabaleshwar Dist. Satara
and has been authorised to carry on the said nursing home For 200 Beds.

Registration No. : SAT / PCH / 01

Date of Registration : 1/4/2022

Place : Satara

Date of Issue of Certificate : 5/9/2022



This Certificate of registration shall be valid up to 31st March 2025
Subject to conditions all staff management, all types of Govt. approvals,
Bio-Medical Waste Management, Fire Safety etc.

The name of Local Supervising Authority,
Swargiya Krantisinha
Nana Patil General Hospital, Satara

8348689
5/9/2022
120,000/-

Civil Surgeon
S.K.N.P. General Hospital, Satara.
Civil Surgeon, Satara

Principal

Bel-Air College of Nursing
Pachgani - 412805



Maharashtra Pollution Control Board,
Satara Nagarparishad Satara,

Association of Hospital Owner's, Satara
(Associate with)

Surya Enviro Waste Management Pvt. Ltd.



BIOHAZARD



CYTOTOXIC

CBMWTF

Office - Flat No. 1, Laxmi Apartment, Survey No. 173 A, Near Monark Hotel, Godoli, Satara - 415001.

RECEIPT

Date - 25/02/2023

Receipt No. : 1

Received With Thanks From

Dr. Name : Dr. Tomy K

Inst. Name : Bel-Air Hospital

Address : 47/2 Siddhnath Wadi, Tal-Wai
Dist - Satara.

By Cash / Cheque / Online : 94559 (online through RTGS)

Date : 21-02-2023

Bank Name : Bank of Maharashtra

Payment Against Month / Year 01-03-2023 TO 31-03-2024

Payment Rs. 2,11,890/- + GST (12%) Rs. 25,427/-

Received Rupees (In Figure) Rs. 2,37,317 2% TDS

The Sum Of Received Rupees (In Words) Two lakh thirty seven thousand three hundred seventeen only

TYPE - HOSPITAL / CLINIC / DENTAL CLINIC / LAB / OTHER

Balance Payable Rs. -

Direct Cheque / Disbursement.
The amount mentioned in this receipt should be paid as per company terms.
Payment Received Name - Abhay Dounde



Abunde
Signature

Signature **Principal**
Bel-Air College of Nursing
Panchgani - 412305



S.K.N.P. GENERAL HOSPITAL, SATARA.

HEALTH DEPARTMENT
FORM C

Certificate of registration Section 5 of the
Bombay Nursing Homes Registration Act 1949

Certificate

No.: SAT / 37

This is to certify that Shri. / Smt. FATHER TOMY K.
has been registered under the Bombay Nursing Homes Registration Act 1949 in
respect of BEL AIR HOSPITAL, WAI.
situated at 47/2 B, Siddhanathwadi, Wai Dist. Satara
and has been authorised to carry on the said nursing home For 73 Beds.

Registration No. : SAT/ 37
Date of Registration : 3/3/2023
Place : Satara
Date of Issue of Certificate : 3/3/2023

This Certificate of registration shall be valid up to 31st March 2026

- Subject to conditions all staff management, all types of Govt. approvals, Bio-Medical Waste Management, Electric Safety etc.
- Subject to conditions fire N. O. C. of Directorate of Maharashtra fire services submit within 24 months from issue date, otherwise this certificate expires.

The name of Local Supervising Authority,
Swargiya Krantisinha Nana Patil General Hospital,
Satara

8348962
3/3/23
43800/-



[Signature]
Principal
Bel-Air College of Nursing
Panchgani - 412805

[Signature]
Civil Surgeon
S.K.N.P. General Hospital, Satara.
Civil Surgeon, Satara